

Spare parts list  
**auma**<sup>®</sup>  
 PROFOX  
 PF-Q80 – PF-Q600

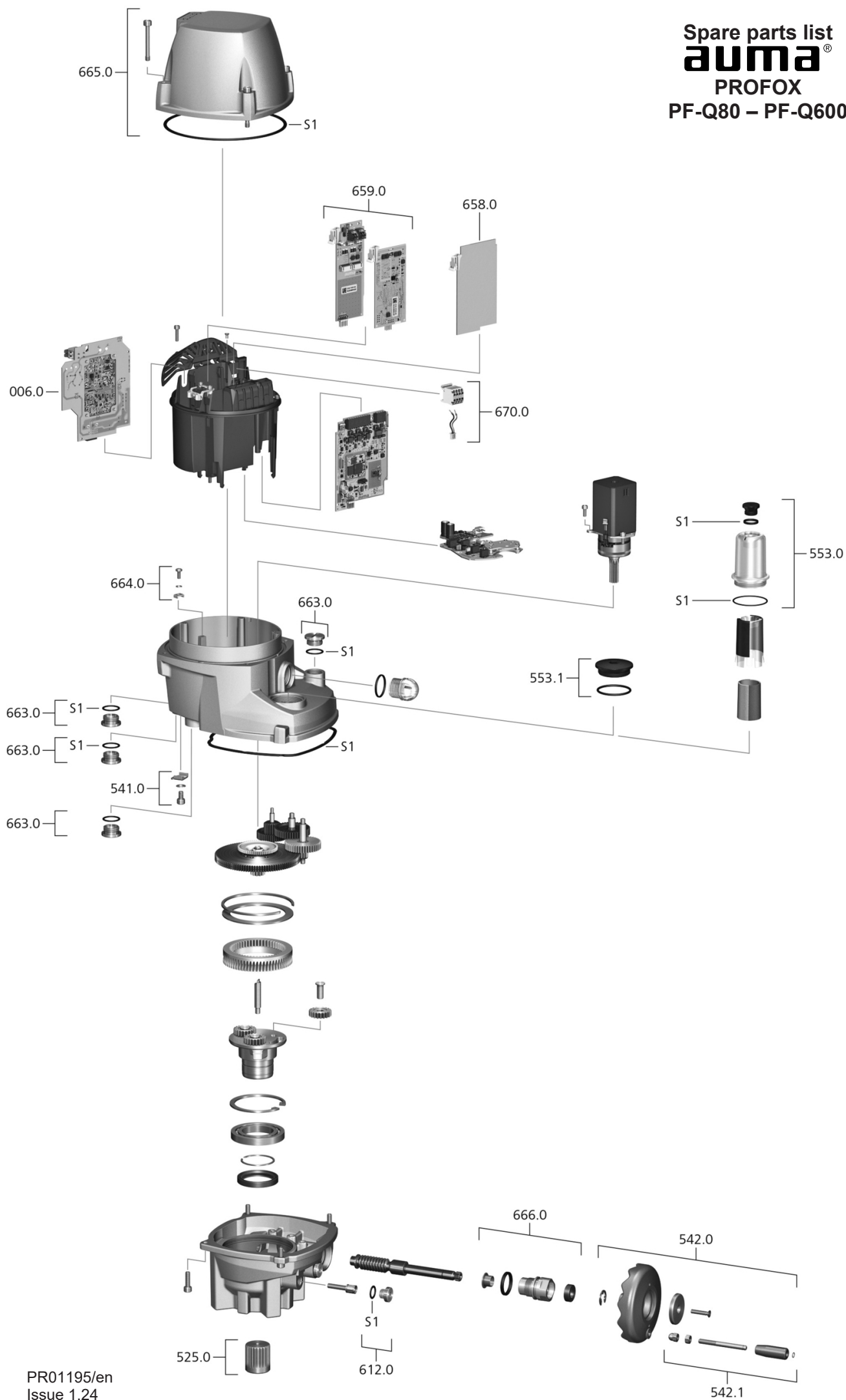

## Spare parts list PROFOX

Please state device type and our order number (see name plate) when ordering spare parts. Only original AUMA spare parts should be used. Failure to use original spare parts voids the warranty and exempts AUMA from any liability. Only the designated spare parts with reference numbers or spare parts sets for replacement are available for the customer. They are specified in the following list. The parts shown in the exploded view without reference numbers may only be replaced by AUMA. Representation of spare parts may slightly vary from actual delivery.

Ref. No.	Designation
006.0	Power supply unit
525.0	Coupling
541.0	Earth connection
542.0	Handwheel with ball handle
542.1	Ball handle
553.0	Mechanical position indicator
553.1	Screw plug M40
612.0	Screw plug for end stop
658.0	I/O board as option
659.0	Fieldbus board (fieldbus and connection board)
663.0	Screw plug for manual emergency operation
663.0	Screw plug for cable gland
664.0	Protective earth connection
665.0	Cover for electronics housing
666.0	Handwheel bearing flange
670.0	Auxiliary voltage output 24 V DC
S1	Seal kit

Note to ref. no. 553.0 Mechanical position indicator: A special tool is required for disassembly/assembly of mechanical position indicator. This can be ordered from AUMA (parts number: V004.027-02).

Note to ref. no. 663.0 Screw plug for manual emergency operation: The manual emergency operation is only available for models PF-Q20 and PF-Q40, which are not equipped with a handwheel.